

ENGINEERING — ARCHITECTURE — SURVEYING  
7 RIDGWAY COURT — P.O. BOX 437 — ELKHORN, WISCONSIN 53121  
PHONE: (262) 723-2098 FAX: (262) 723-5886

LOTS H5, H6, & H7 COUNTRY CLUB ESTATES ADDITION H  
LOCATED IN THE SW 1/4 OF THE SW 1/4 SECTION 14  
TOWN 1 NORTH, RANGE 16 EAST  
VILLAGE OF FONTANA—ON—GENEVA LAKE  
WALWORTH COUNTY, WI

- WORK ORDERED BY -  
CHUCK PALMA  
880 TARRANT DRIVE  
FONTANA, WI. 53125

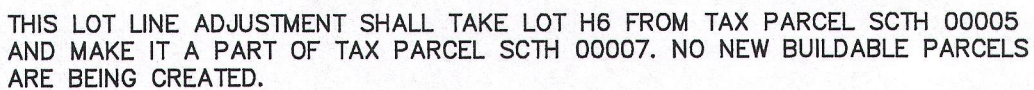

NOTE: COPIES OF THIS MAP TO WHICH THE FOLLOWING CERTIFICATE  
WILL APPLY SHOW THE SURVEYOR'S ORIGINAL SEAL AND SIGNATURE  
IN RED INK. COPIES BY ANY OTHER MEANS MAY HAVE ALTERATIONS  
WHICH DO NOT REPRESENT THE SURVEYOR'S WORK PRODUCT.

I HEREBY CERTIFY THAT THE ABOVE DESCRIBED PROPERTY HAS BEEN SURVEYED UNDER MY DIRECTION AND THAT THE ABOVE MAP IS A TRUE REPRESENTATION THEREOF AND SHOWS THE SIZE AND LOCATION OF THE PROPERTY AND ITS EXTERIOR BOUNDARIES. THIS SURVEY IS MADE FOR THE USE OF THE PRESENT OWNERS OF THE PROPERTY, AND ALSO THOSE WHO PURCHASE, MORTGAGE, OR GUARANTEE THE TITLE THERETO WITHIN ONE YEAR FROM THE DATE HEREOF.

DATED: JUNE 18, 2015

PETER S. GORDON P.L.S. 2101

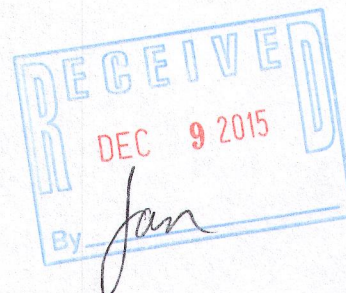

PROJECT: 9301  
DATE: 06-18-2015  
SHEET 1 OF 1